

AXIØMA
METERING

V01_2021



QALCOSONIC W1

↔ DN15, DN20, DN25, DN32, DN40



WWW



ISO 4064-1-2017



M1
2014/32/UE



E1 / E2
ISO 4064:2014
2014/32/EU

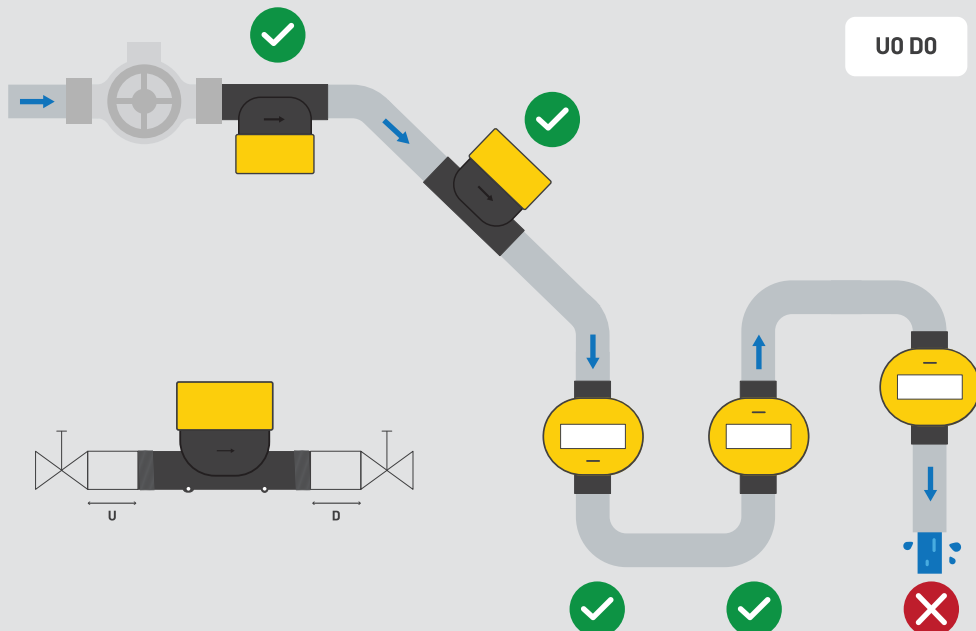

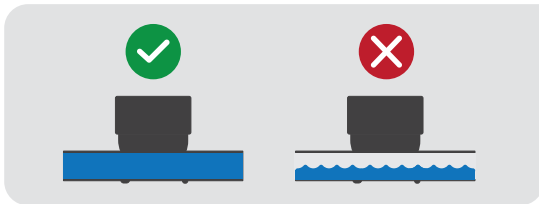
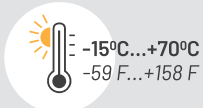
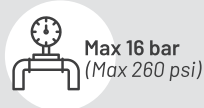
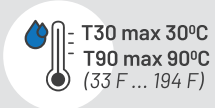

DN15	DN20	DN25	DN32	DN40
27 mm	31 mm	41 mm	49 mm	55 mm
30 Nm	35 Nm	40 Nm	40 Nm	40 Nm

